



M6 TREADMILL

SKU: CT-M6 (DC)

SKU: CT-M6 (AC)



Intuitive, easy-to-use console w/reading rack/tablet holder & raised shifters for speed & elevation



25,000 mile maintenance-free running belt



4.25 HP DC or 3.5 HP AC maintenance-free drive system



STANDARD FEATURES

- Powerful high-efficiency 4.25 HP DC motor **OR** 3.5 HP AC motor.
- 60"L x 20"W lubricant infused, Thermoplastic Polyurethane (TPU) running belt.
- Shock-absorbing, reversible deck.
- Contact and telemetric heart-rate sensors.
- Cooling fan, speakers and USB charging port.
- Space saver - small footprint.
- Zinc-dipped anti-corrosion coating for superior rust protection.
- Full commercial components on a durable light commercial frame.
- Easy-to-move front-mounted dual wheels.

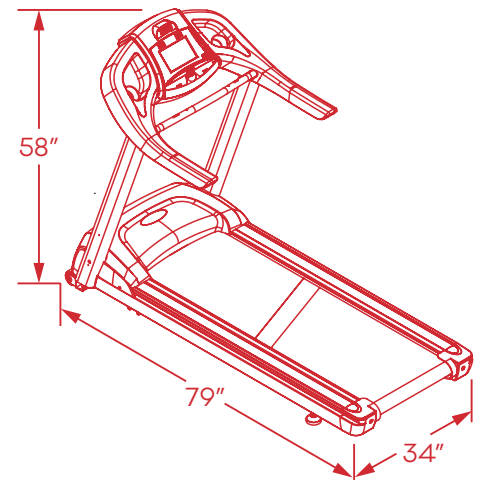



TECHNICAL SPECIFICATIONS	DECK	Chenxun™ Reversible Deck
	BELT	DC: Newworld™ Commercial Grade AC: Habasit™ Commercial Grade
	RUNNING AREA	60 X 20 in (1520 X 500 mm)
	SPEED RANGE	0.5 ~ 12.5 mph (0.8 ~ 20 km)
	INCLINE RANGE	0-15% (15 levels)
	STEP-UP HEIGHT	6.7 in (170mm)
	ROLLERS	2.7 in (70mm)
	MAXIMUM USER WEIGHT	450 lbs (204 kgs)
ELECTRICAL SPECIFICATIONS	POWER REQUIREMENT	110Vac ~ 220Vac ± 20%, 20A, 50/60Hz
	DRIVE SYSTEM	4.25 HP DC or 3.5 HP AC Motor (Treadmill Duty)
FRAME	FRAME MATERIAL	Zinc-dipped, powder-coated steel frame
	COLOR OPTIONS	Jet Black
	NET WEIGHT OF FRAME & CONSOLE	DC: 288.2 lbs (131 kgs) AC: 301.4 lbs (137 kgs)
	PACKAGED WEIGHT	DC: 316.8 lbs (144 kgs) AC: 330 lbs (150 kgs)
DIMENSIONS	EQUIPMENT DIMENSIONS	79 (L) X 34 (W) X 58 (H) in / 1990 (L) X 860 (W) X 1400(H) mm
	PACKAGING DIMENSIONS	83 (L) X 35 (W) X 16 (H) in / 2100 (L) X 880 (W) X 400 (H) mm

CONSOLE SPECIFICATIONS

DISPLAY	SCREEN	8x16 Dot-Matrix w/ Message Window + HR Status Bar
	LANGUAGE OPTIONS	English
	PRE-PROGRAMMABLE WORK OUTS	Yes, 9
	QUICK START OPTIONS	N/A
CONNECTIVITY	USB	Standard
	LAN	No
	CSAFE COMPLIANT	Optional
	BLUETOOTH	No
	HEART RATE (HR) DETECTION	Hand Pulse (5kHz Wireless)
FEATURES	FAN	Yes
	READING RACK	Yes
	TARGET HEART RATE ZONE	Yes
	BOTTLE HOLDER STORAGE	Yes